

1. TOPOGRAPHIC CONTOUR INTERVALS ARE 5 FEET. DATUM IS MEAN SEA LEVEL ELEVATION.
2. THE AERIAL CONTOURS ILLUSTRATE THE HEIGHT LIMITATIONS WITHIN EACH ZONE.
3. A SLOPE, SUCH AS 40:1, EXPRESSES THE HORIZONTAL DISTANCE OF 40 FEET TO THE VERTICAL DISTANCE OF 1 FOOT.
4. EXISTING TOPOGRAPHIC SYMBOLS ARE THOSE USED BY THE U.S. GEOLOGICAL SURVEY.
5. IN THOSE AREAS WHERE EXISTING TERRAIN OR TREES PENETRATE ONE OR MORE OF THE IMAGINARY SURFACES THE HEIGHT OF STRUCTURES SHALL BE RESTRICTED TO ONLY THE HEIGHT OF THE TREE CANOPY WHICH PROVIDES A NATURAL SHIELD TO THE STRUCTURE.

PREPARED BY R.D. CADY	DATE 7/28/80	REG. NO. 442	EXT. 442
CHKD BY [ ]	DATE [ ]	CHKD BY [ ]	DATE [ ]
APPROVED [ ]			

TITLE PINEY - PINECREEK BORDER AIRPORT	DWG. NO.
AIRSPACE OBSTRUCTION ZONING	
SCALE 1" = 1000'	
SHEET 1 OF 3	



**MINNESOTA DEPARTMENT OF TRANSPORTATION**  
**AERONAUTICS DIVISION - AIRPORT DEVELOPMENT**  
 417 TRANSPORTATION BUILDING, ST. PAUL, MN. 55155

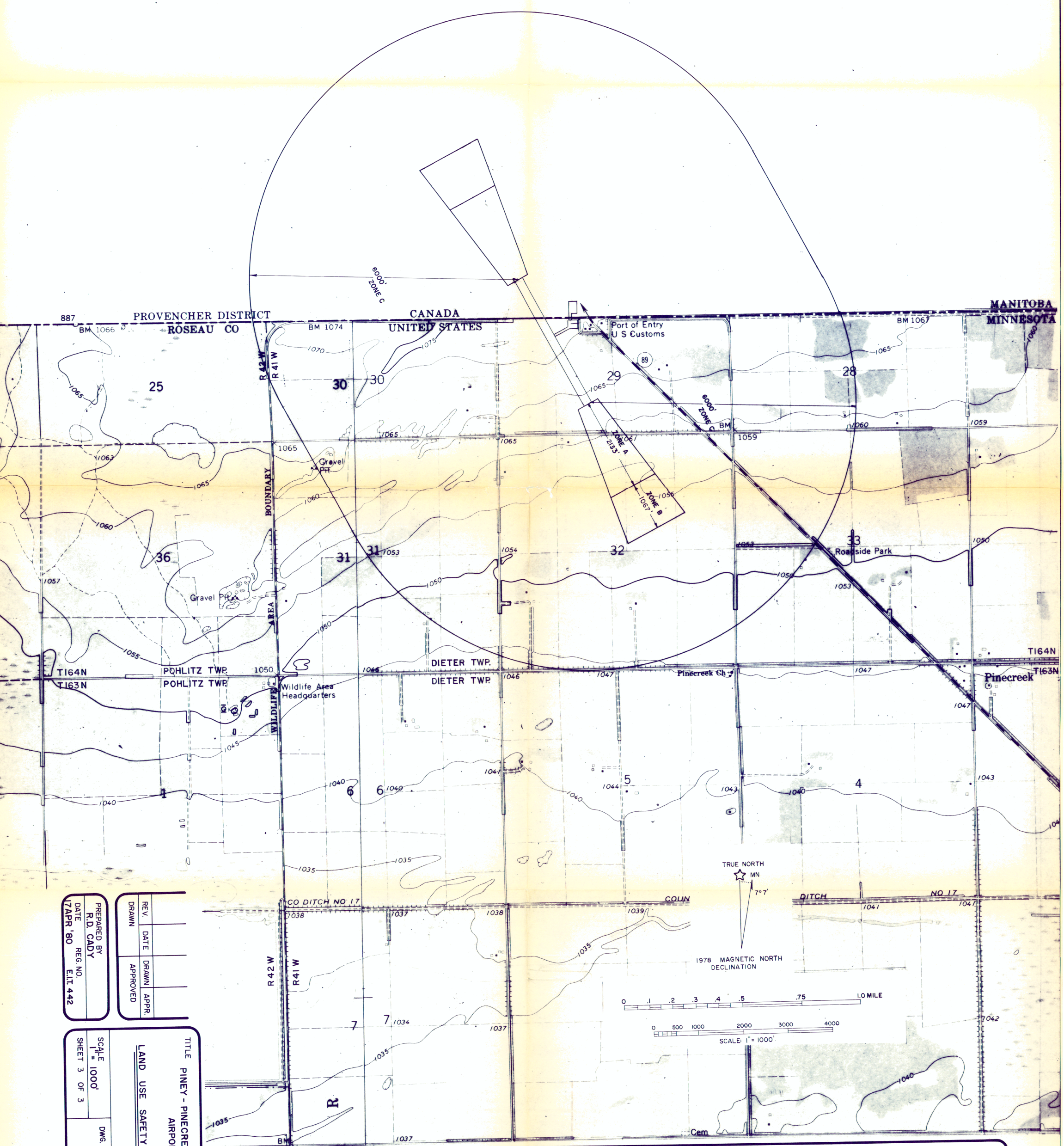

PREPARED BY  
R.D. CADY  
DATE REG. NO.  
7 APR 80 E.L.T. 442

REV.	DATE	DRAWN	APPR.
DRAWN		APPROVED	

SCALE  
1" = 1000'  
SHEET 3 OF 3

TITLE  
PINEY - PINECREEK BORDER  
AIRPORT  
LAND USE SAFETY ZONING

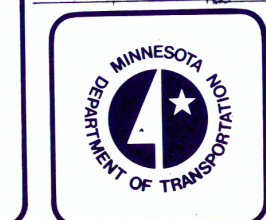

**MINNESOTA DEPARTMENT OF TRANSPORTATION**  
**AERONAUTICS DIVISION - AIRPORT DEVELOPMENT**  
 417 TRANSPORTATION BUILDING, ST. PAUL, MN. 55155

